

Manual with instalation proces BMW v8 enigne with 8HP70.

www.adamat.com.pl

E-mail: adamat@poczta.onet.eu

REMARKS!!! All metal Surfaces must be clean and degreased.

1. In first step please assy adapter on engine and check is starter motor fit without nescassary changes in adapter. Sometimes chamfer must be done.

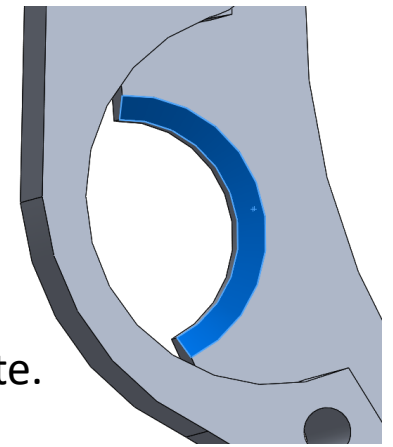

2. Please bolt tansmission on adapter and make sure that end of bolts are maximum on adapter plate. To long bolts can touch trigger ring on flywhell and damage it. If bolts are to long please cut it. We recomended fit tranmission on engine together with eariel assembled adapter plate.

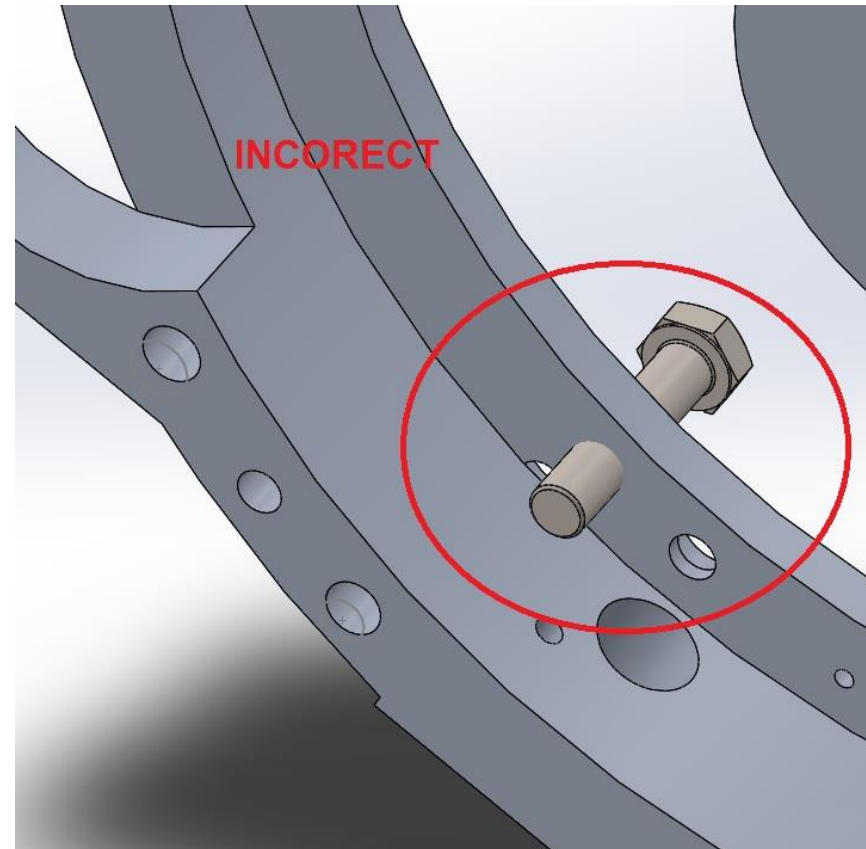
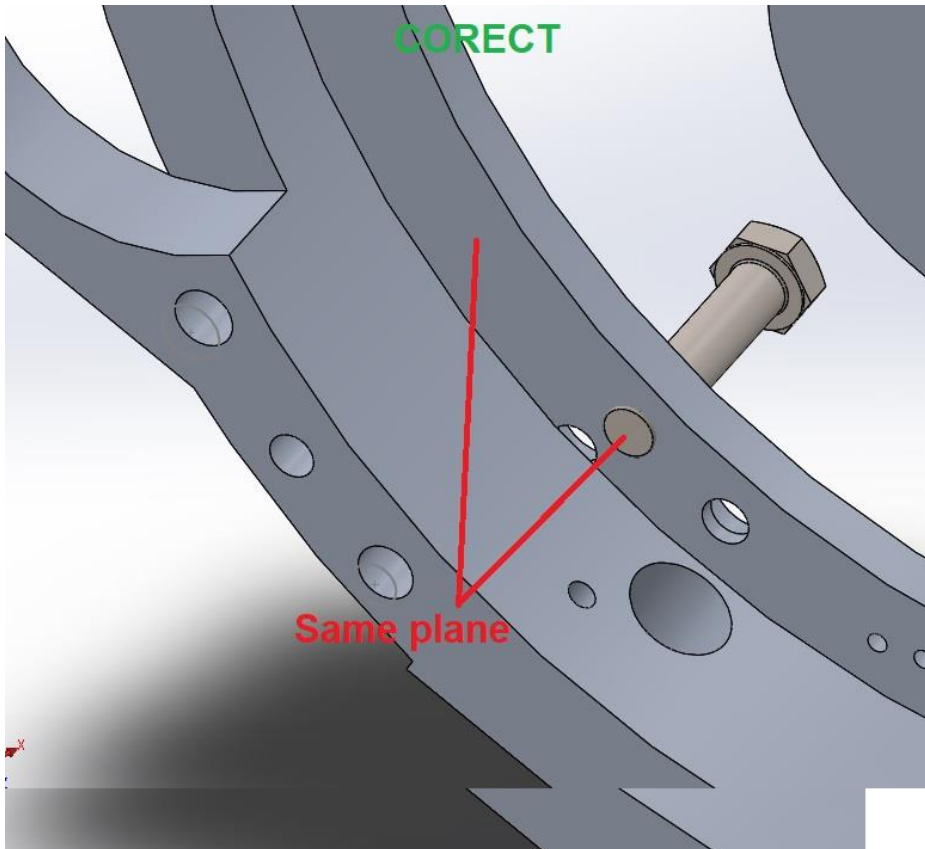

BMW 8HP45-70 6 bolts flat torque converter
N47/N57/B47/B58/B57

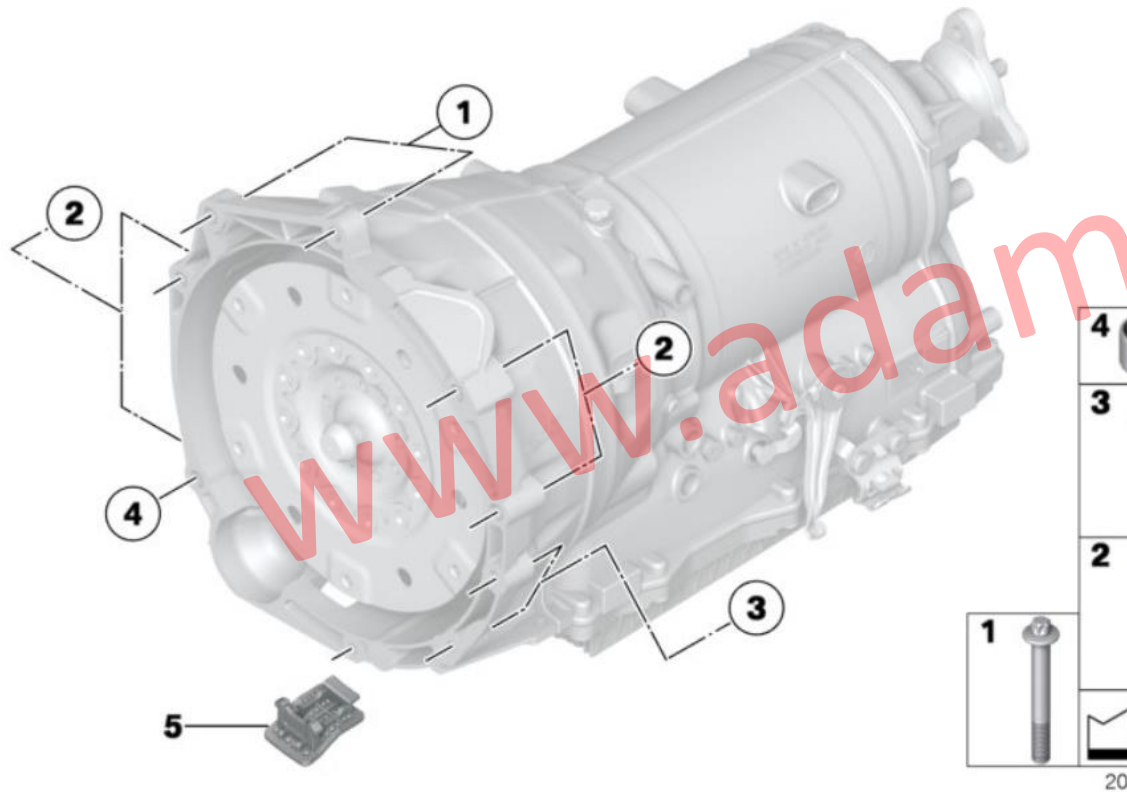

- 1 – M12x1,5x40 2PCS
- 2 – M12x1,5x60 3PCS
- 3 – M8x45 3PCS



www.adamat.compl

Adapter on engine basic bolts chart.

Important in adapter plate on opposite site are two holes for positioning Slaves 14,5mm that should be assembled in engine block.

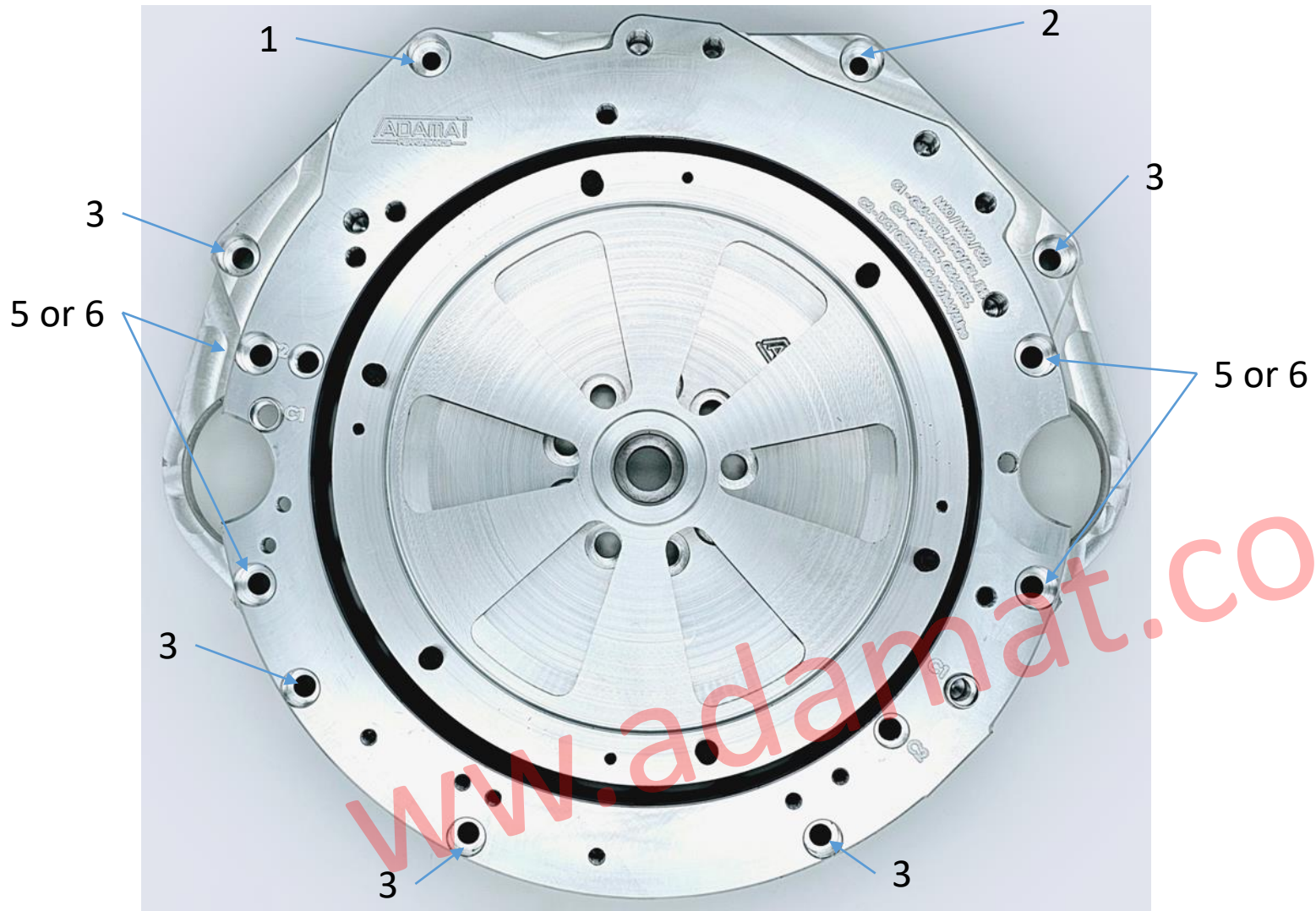

No	Bolts type	Size	Qty
1	DIN912	M8x40	1
2	DIN912	M8x50	1
3	DIN912	M10x55	6
5	DIN912	M10x60 + washer + NUT on site without starter motor	2
6	DIN912	M10x50	2

3. Assy main flywhell

Torque for bolts from kit M12x1.5 12.9 class

- use lubricant soft threadlocker
- first stage 49Nm
- Secound stage 65Nm
- final stage 115Nm

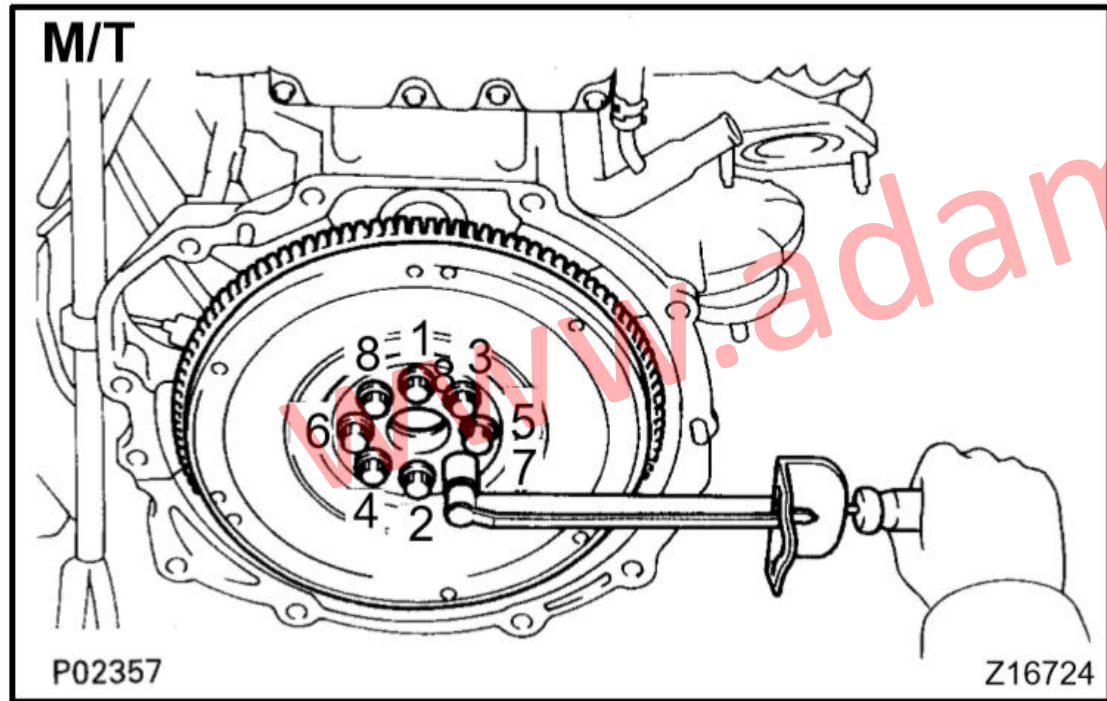

4. Assy torque converter on torque adapter

Torque for 6 torque converter bolts

DIN912 M10x30 12.9class

-use lubricant soft threadlocker

-first stage 49Nm

-Secound stage 65Nm

-final stage 93Nm

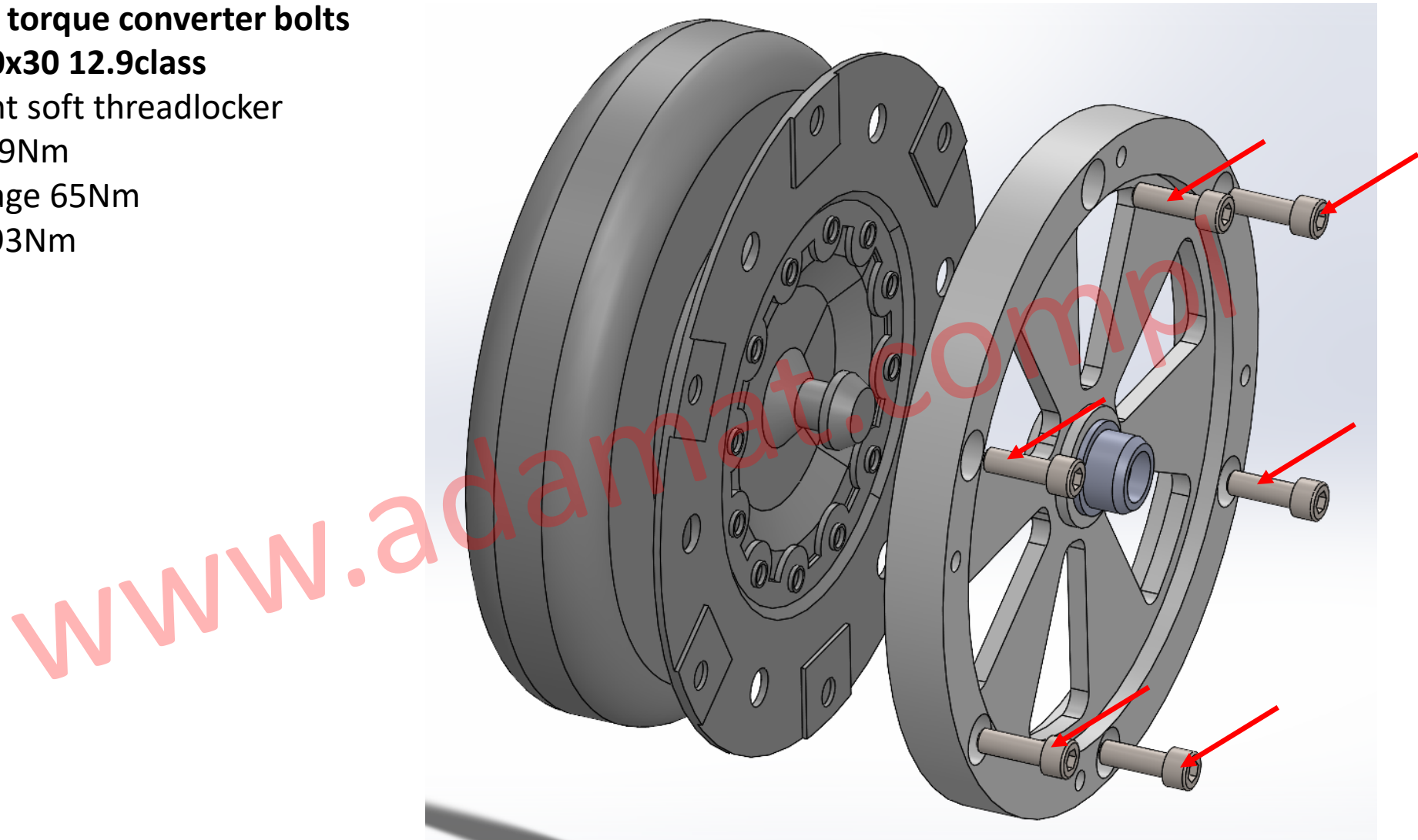

5. In final assy tranmission with torque converter on engine with standard automatic tranmission installation procedure

6. Bolt torque converter adapter with main flywheel using 4 bolts DIN912 M10x30 12.9class

Torque for 6 torque converter bolts

DIN912 M10x30 12.9class

- use moly grease on bolts.
- first stage 49Nm
- Second stage 55Nm
- final stage 79Nm

